

Assembly Instructions

7150 Carbide / Quantum Fun Kart



BEFORE OPERATING THIS VEHICLE, THE OWNER AND EACH OPERATOR MUST UNDERSTAND THAT THIS VEHICLE WAS NOT DESIGNED OR MANUFACTURED TO MEET SPECIFICATIONS FOR USE ON PUBLIC ROADS, STREETS, HIGHWAYS, AND THOROUGHFARES AND HAVE TO READ AND HAVE AN UNDERSTANDING OF ALL THE INSTRUCTIONS FOR PROPER ASSEMBLY AND SAFE OPERATION, AS WELL AS THE INSTRUCTIONS CONCERNING THE ENGINE AND ALL OTHER PORTIONS OF THE VEHICLE.

Required Tools:

- | | |
|-------------------------------|-------------------------|
| - Hammer | - Side Cutters |
| - Box Cutter or Utility Knife | - Pry Bar |
| - 8mm Socket | - 19mm wrench |
| - 10mm Socket | - Side Cutters |
| - 12mm Wrench | - Pry Bar |
| - 14mm Socket | - Safety Glasses |
| - 10mm Wrench | - Phillips Screw Driver |



CAUTION: Wear proper eye protection during the uncrate and assembly process to avoid potential eye injuries

1 – Uncrating the Unit

- Using hammer and pry bar, remove end cross supports and discard.
- Carefully pry and remove crate top and discard.
- Remove crate sides and discard.
- Using side cutters, remove the hold down ties.
- Roll the kart off of the crate base and discard base.

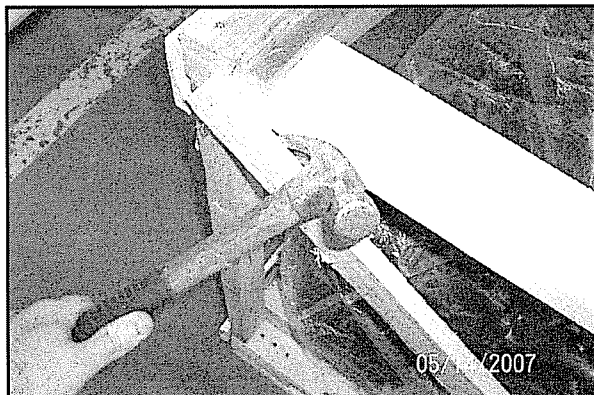

2 – Unpacking the Unit

- Unpack all of the loose components from the unit and set aside for assembly.
- Remove protective plastic each component and discard.

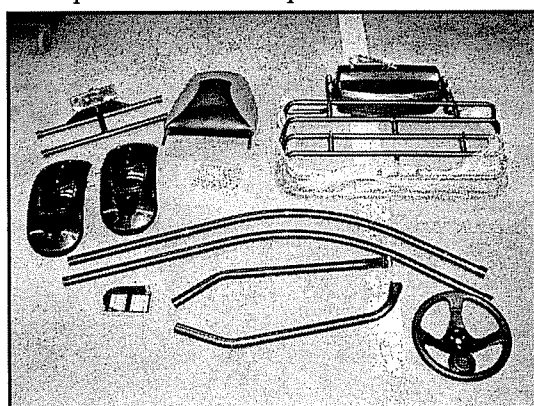



WARNING: Wear eye protection and prevent the battery acid from coming into contact with skin, eyes, and clothing. Contact with skin or eyes will result in severe burns and contact with clothing may decompose the material. If skin or eye contact is made, flush immediately with water and contact a doctor.

3 – Battery Installation

- The battery has been pre-installed on this unit for simplified assembly.
- Remove the rubber battery hold down and top cover to expose the battery terminals.
- Using a Phillips screwdriver, install the GREEN wire to the (-) battery terminal.
- Using a Phillips screwdriver, install the RED wire to the (+) battery terminal.
- Cover the terminal with the protective cap included on the wire.
- Install the battery cap and rubber hold down strap to secure that battery in the tray.

NOTE: The battery for this unit has been fully charged by the manufacturer prior to shipment. However, additional charging by the end user may be required if the unit was stored in inventory for any length of time. Charge the battery using a 2amp-12Volt trickle charger until the battery has reached its full charge.

4 – Steering Wheel Installation

- Locate the steering wheel and fasteners (A) and (B) as identified on the fastener reference sheet at the end of this document.
- With the front wheels aligned in the straight-ahead position, orient the steering wheel with the third spoke in the 6:00 position.
- Using an 8mm socket and ratchet or wrench, install the bolts with lock washers and tighten to secure the steering wheel.
- Align the steering wheel cover and snap into place.

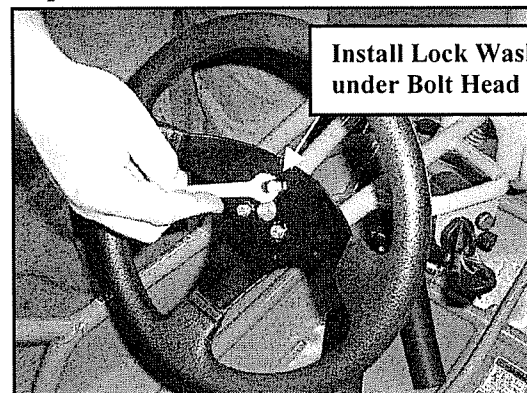
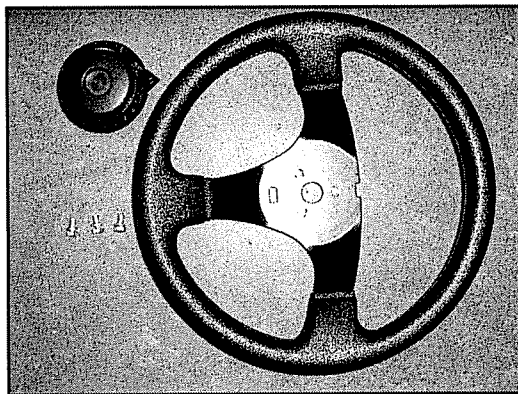

**Install Lock Washer
under Bolt Head**

5- Headrest Installation

- Slip each headrest into the seat back openings.

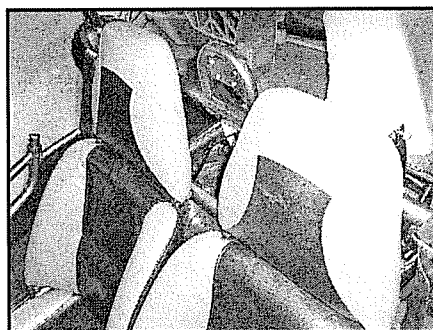

6 – Overhead Bar Installation

- Overhead bars must be installed using the special washers (D) as shown on the fastener reference sheet.
- Reference the figures below for proper fastener installation.

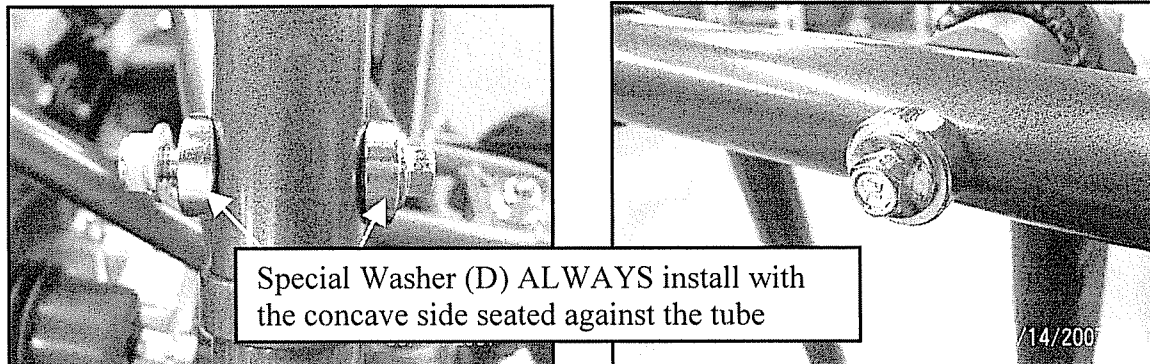

- Align and place the center bar on the (2) frame mounts located behind the seats.
- Install fasteners (G), (D) and (E) as shown in the previous figures, and finger tighten.

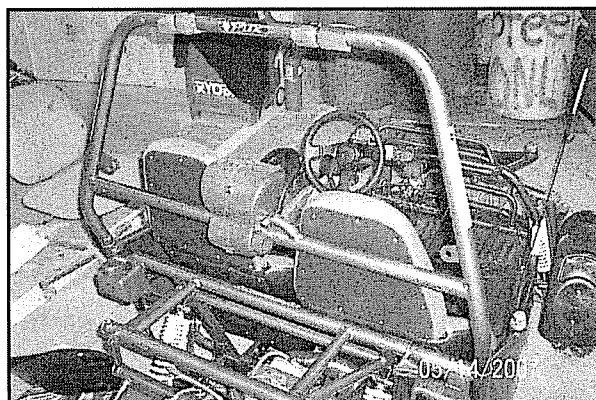

- Align and place the (2) front bars on the frame mounts and install fasteners.
- Finger tighten the fasteners, ensuring that all washers are placed correctly.
- Align and place the Overhead cross bar assembly into position and install fasteners.

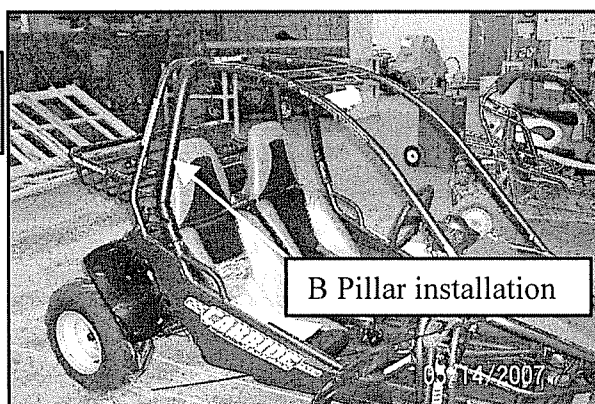
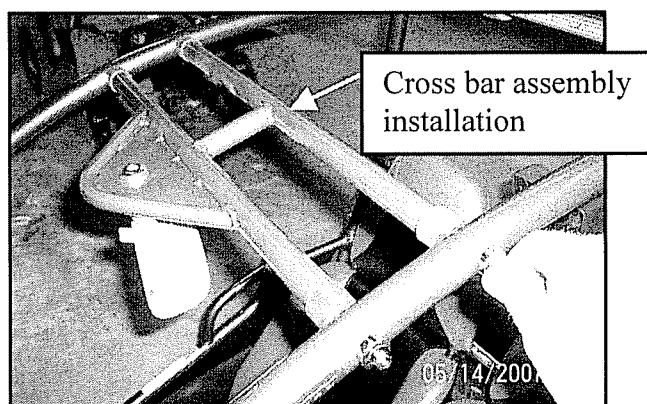

- Align the rear rack with the center bar and install fasteners (D) and (G).
- Install the rack support tubes and install fasteners (K) and (E).

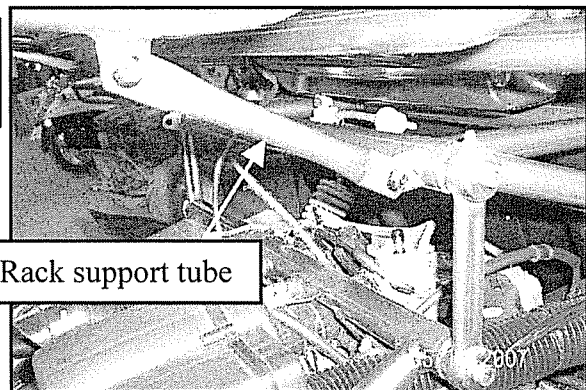
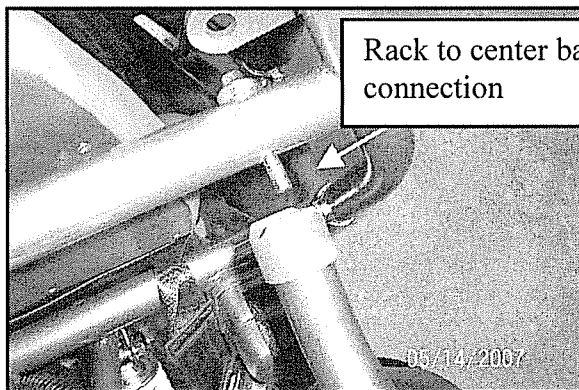

- With all the fasteners installed, begin to tighten each connection point using a 10mm socket wrench and 12mm wrench as required
- Ensure that the special washers (D) are fully seated against the tube as the fasteners are tightened.

7 – Front Fender Installation

- Locate the front fender assemblies.
- Locate fasteners (H) and (F) to mount each fender.
- Align each fender in the mounting bracket hole and install fastener (E) and (C).
- Tighten using a 8mm socket and 10mm wrench.

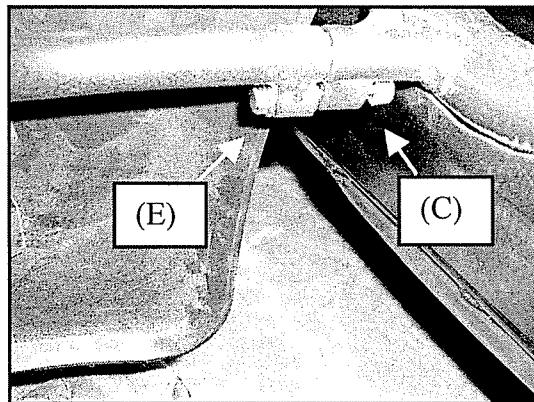
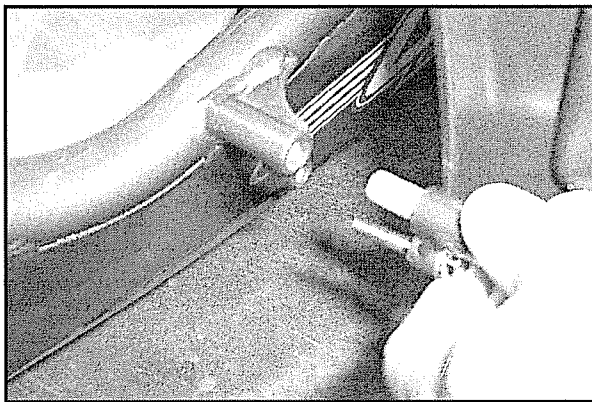

8 – Final Connections

- Under the fuel tank, locate the vacuum and Fuel line as indicated in the figure below
- Connect the vacuum line from the fuel tank to the "T" connection from the carburetor as indicated in the figure below. Ensure that the spring clamp is securely in place.
- Connect the fuel line from the tank (line with the filter) to the carburetor fuel line (line with protective spring covering) as indicated in the figure below. Ensure that the spring clip is securely in place.

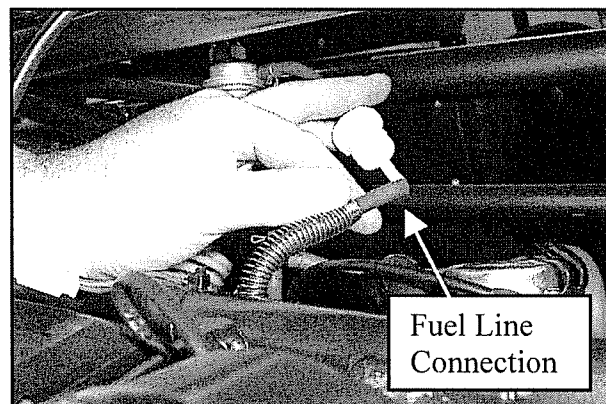
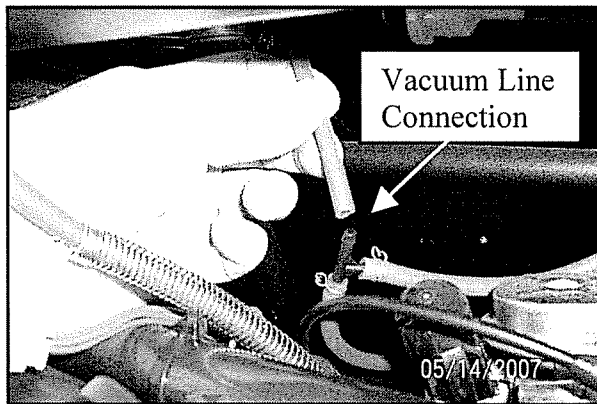

- The taillight connects using a simple wire plug. Connect the taillight to the plug located just in front of the electrical control box on the engine.



- Locate the snorkel hose coming from the engine air box and connect the loose end to the snorkel located between the headrests.

9 – Flag Installation

- The flag fasteners (J), (L) and (N) have been pre-installed onto the right rear corner of the rear rack.
- Simply loosen the plastic nut (N) from the underside of the rack and slip the flag into place.
- Finger tighten the plastic nut to retain the flag.

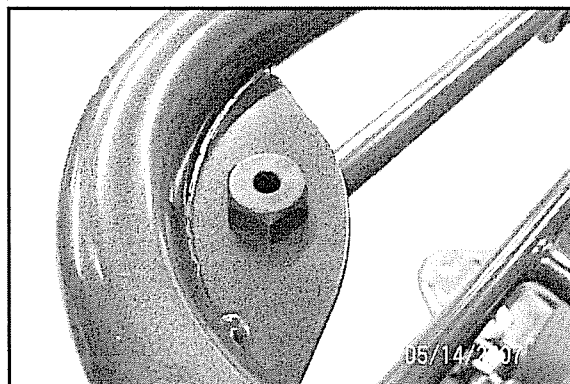

10 – Seat Belt Shoulder Connection

- Locate fasteners (P), (M), (Q) and (C).
- Remove the plastic cover from the seat belt bracket and stack the hardware as shown in the figure below.
- Install the lock washer and nut and tighten using a 14mm socket and 19mm wrench.

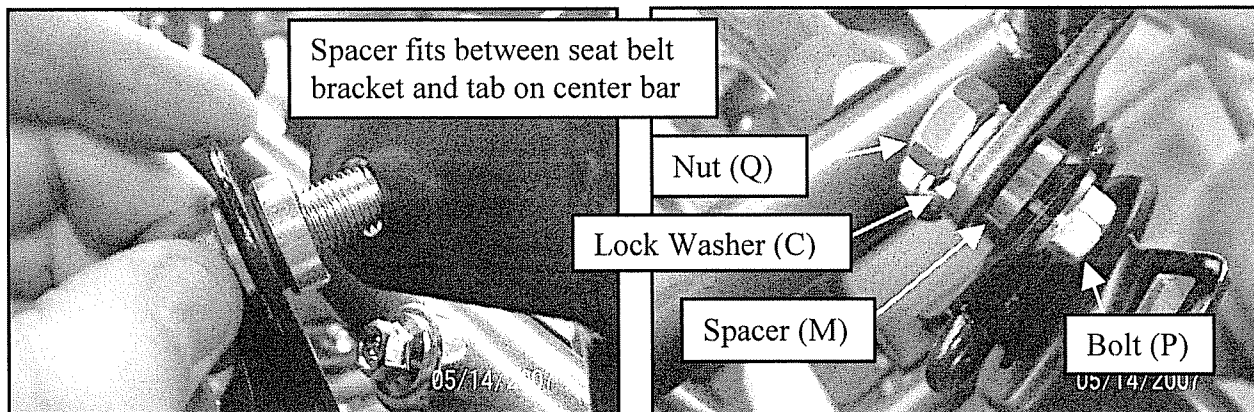

11 – Final Preparation

- Fill the fuel tank with clean, fresh mid grade gasoline
- Check the engine oil level per the supplied Owner/Operator manual
- Refer to the supplied Owner/Operator manual prior to operating your new Fun Kart

FASTENER REFERENCE SHEET

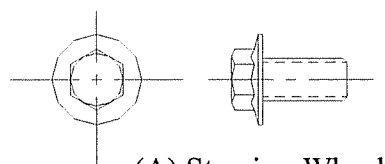

(A) Steering Wheel

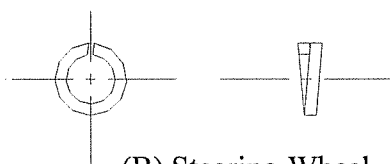

(B) Steering Wheel



(C) Seat Belt

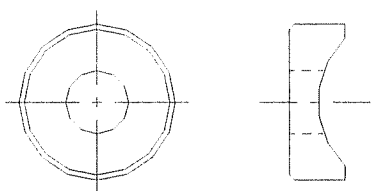

(D) Overhead Bars

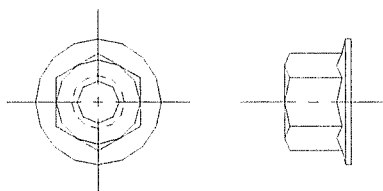

(E) Overhead Bars

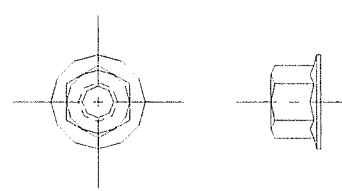

(F) Fender Attachment

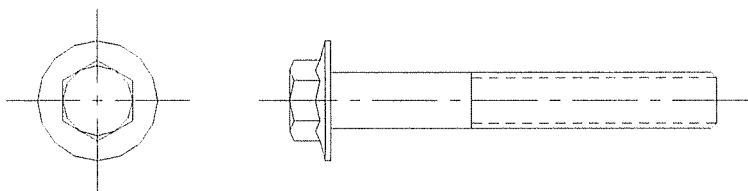

(G) Overhead Bars

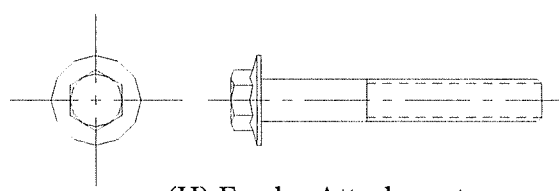

(H) Fender Attachment

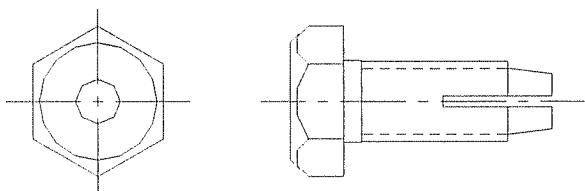

(J) Flag Mounting

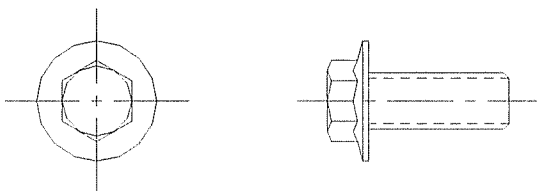

(K) Rear Rack Support

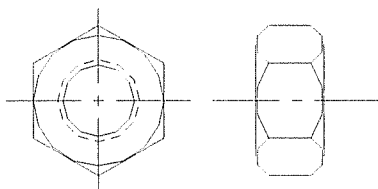

(L) Flag Mounting

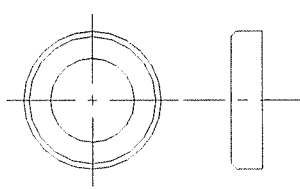

(M) Seat Belt

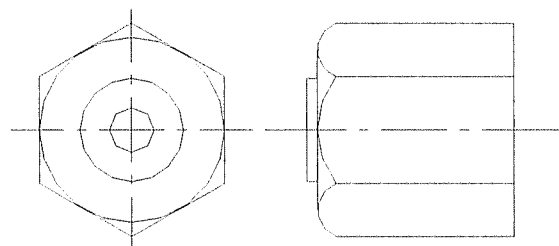

(N) Flag Mounting

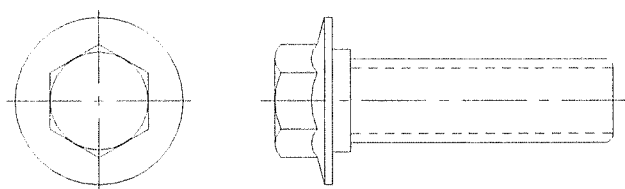

(P) Seat Belt

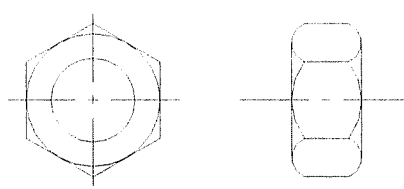

(Q) Seat Belt